

**CONCEPT INFO**

Level P1 -  
Parking (79 Stalls) - 31,460 SF

Level 1 Retail - 2,996 SF  
Level 1 Housing - 14,363 SF  
Lobby & Service Utility - 5,653 SF  
Rentable (Units) - 6,187 SF  
Level 1 - Parking Ramp - 2,523

Typical Level (2-5) - 19,208 SF  
Rentable (Units) - 17,145 SF

**TOTALS**

Total Housing SF = 88,672 SF  
Total Units 88,672 / 900 SF = 98 Units  
Total Rentable SF = 74,767 SF  
Total Parking SF = 33,983 SF

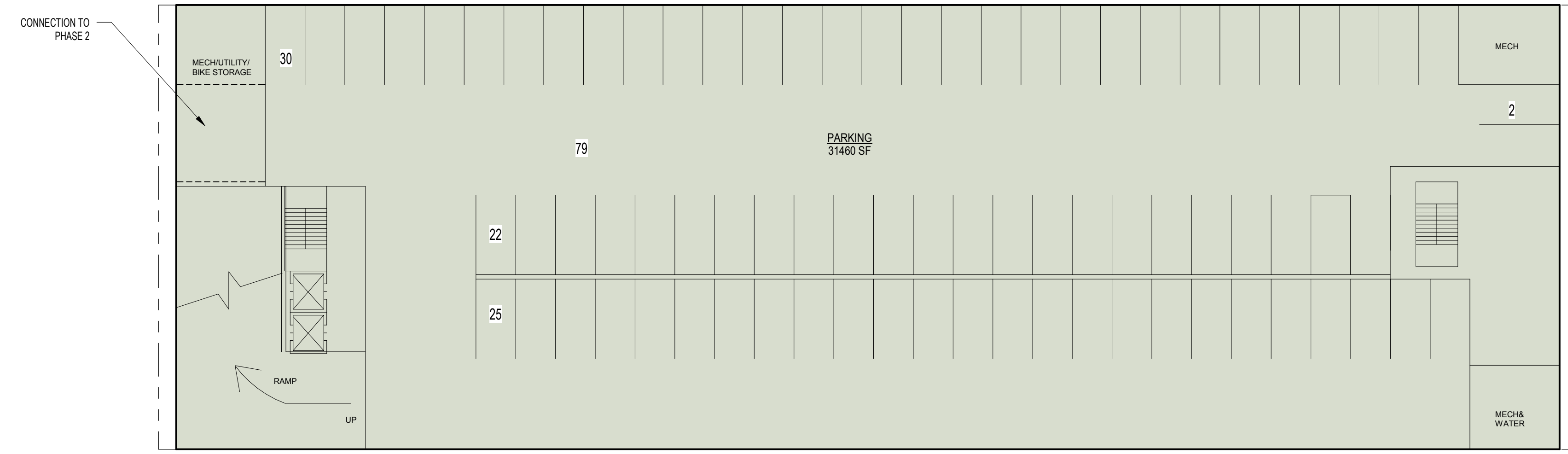
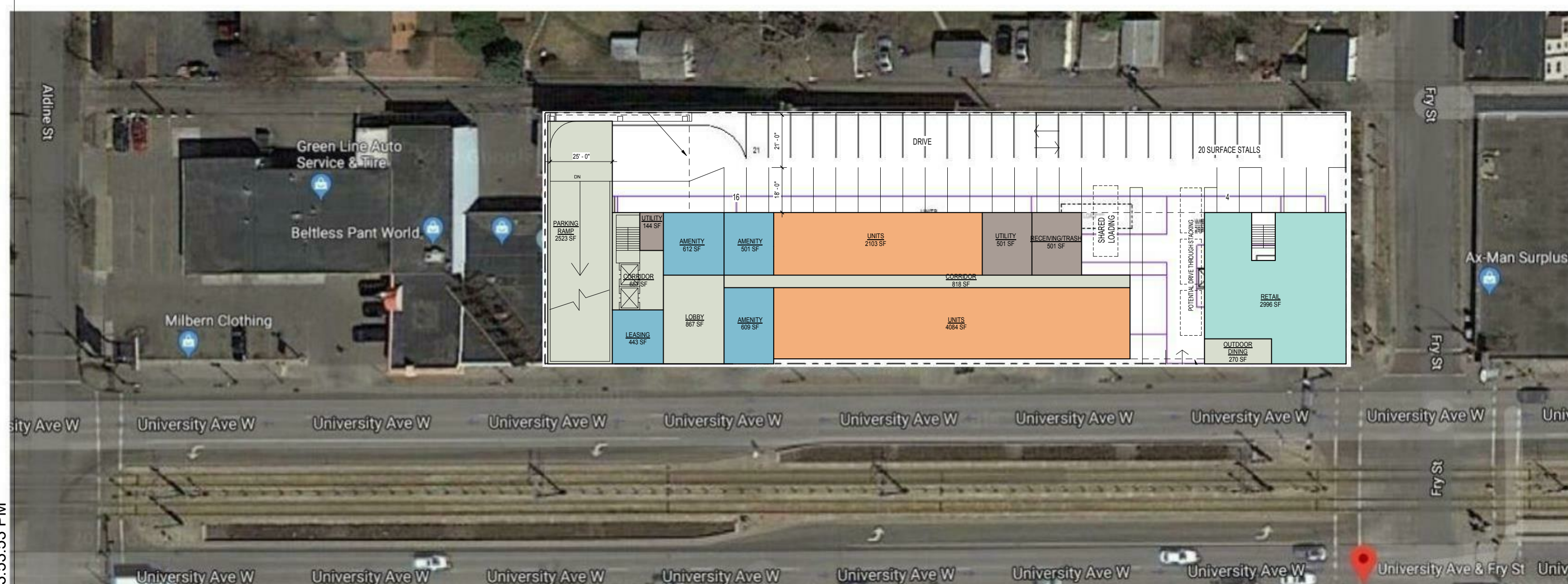

LOWER LEVEL PARKING

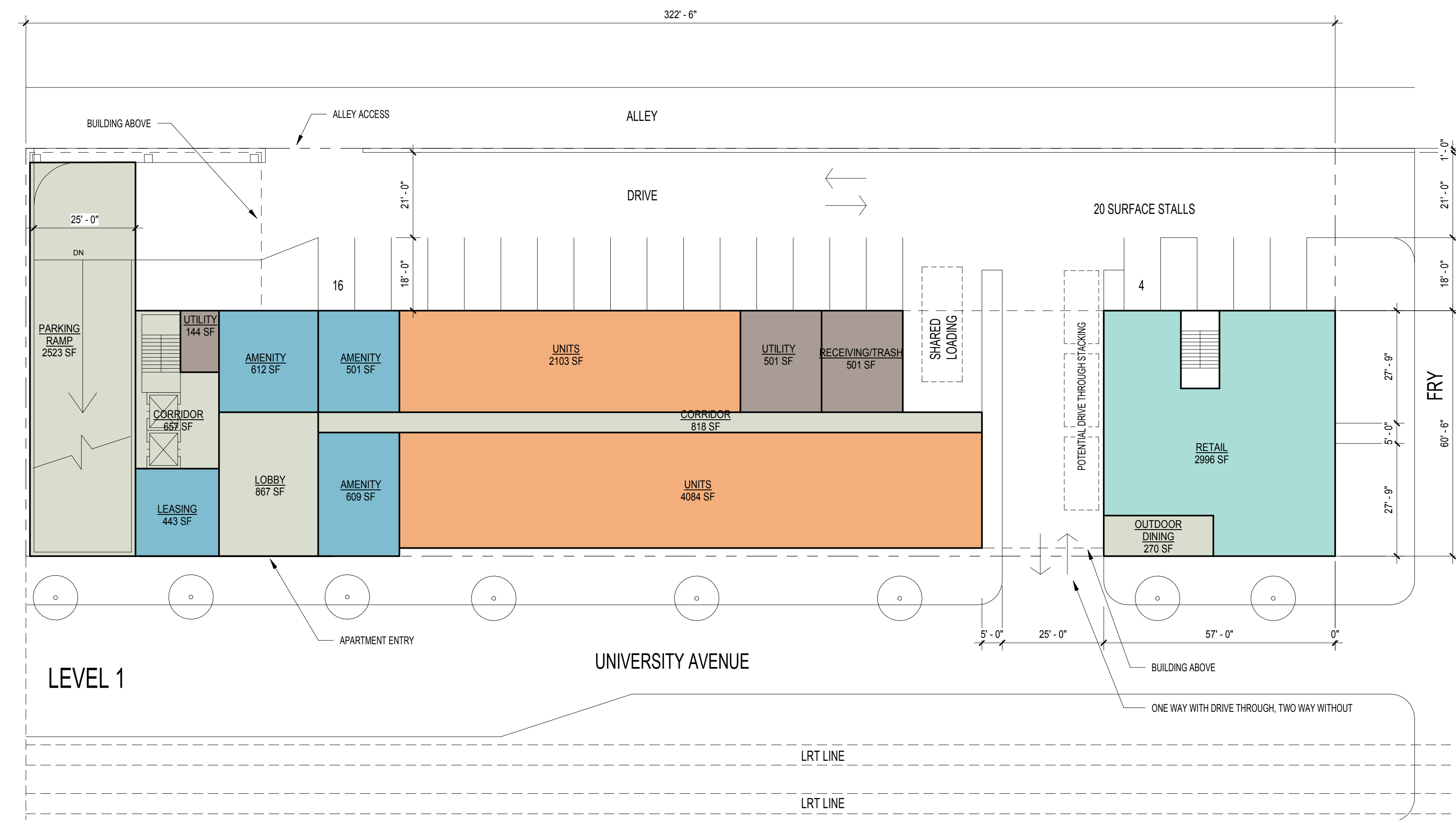

LEVEL 1

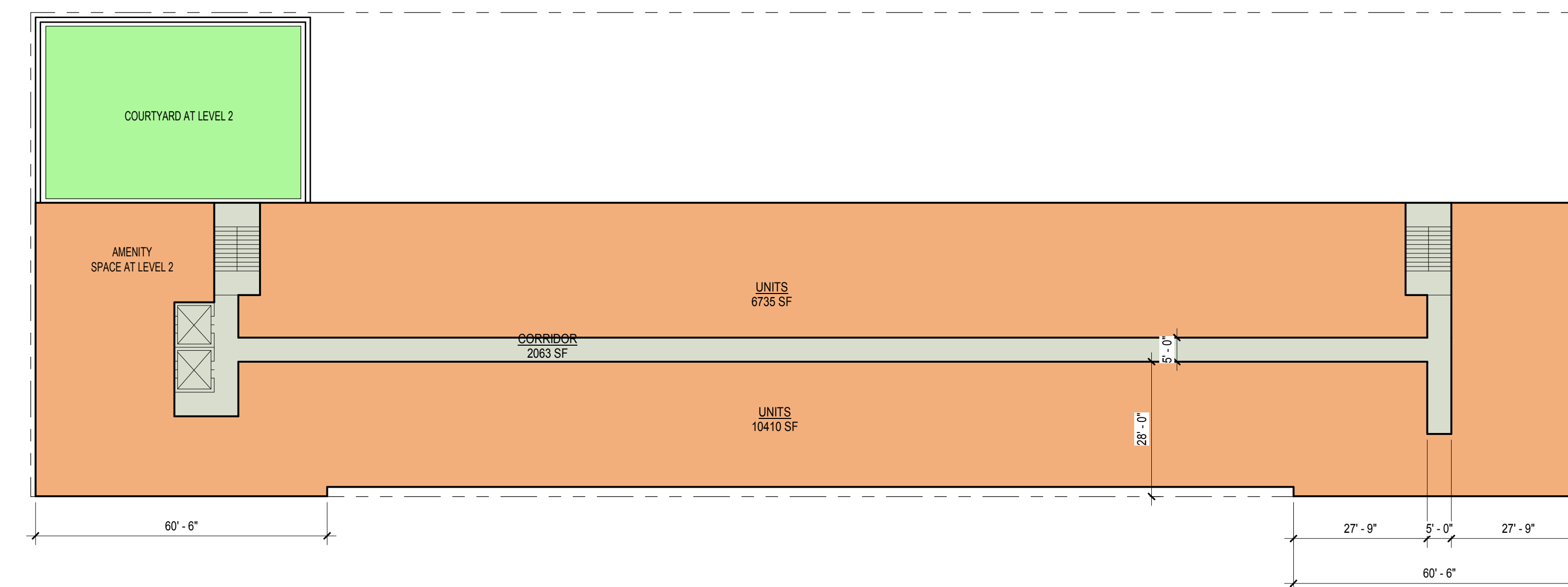

LEVELS 2-5

CERTIFICATION

**NOT FOR  
CONSTRUCTION**

DRAWN BY: \_\_\_\_\_ Author  
CHECKED BY: \_\_\_\_\_ Checker  
COMMISSION NUMBER: XXXX-XXX

SHEET TITLE

CONCEPT A

SHEET NUMBER

1

